

V30/BID304(P)/EE/201605

Practical Examination

Time : 6 Hours

Max. Marks : 60

Instructions for the students:

1. All questions are compulsory.
 2. Assume suitable data if necessary.
 3. Figures to the right indicate full marks.
 4. Select appropriate scale and mention the scale used.
 5. Neatness will be considered for additional marks.
-
1. For residential flat of 2BHK in Navi Mumbai, suggest energy conservation methods/strategies along with energy efficient systems. 40
Give detailed specification of any one chosen aspect for the entire house.
(Assume suitable data whenever necessary.)
Requirements showing details of green measures adopted to a suitable scale, blow up where required.
 - Detailed plans
 - Any two sectional elevations
 - Specification charts in tabular form

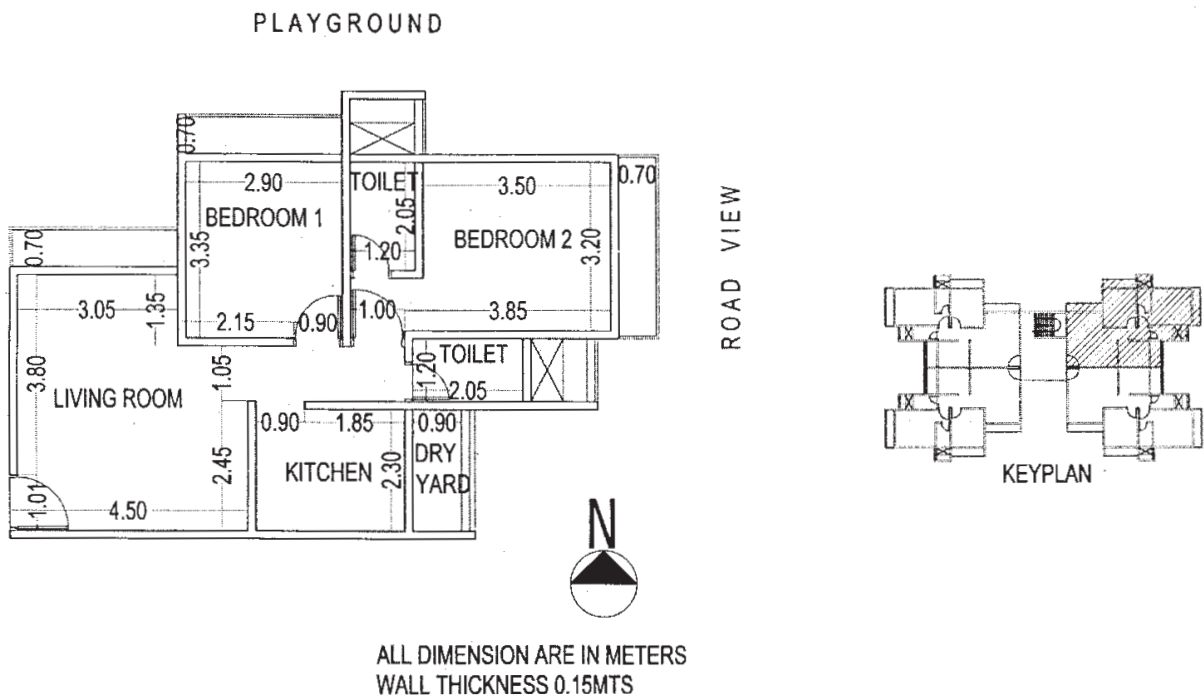

2. Answer any four from the following questions.

20

- i) Explain the term "pollution".
- ii) Describe the Indian climatic zones stating their climatic characteristics and distribution of the same.
- iii) Select any climatic zone of your choice and using climatic characteristics state any five design features to be implemented architecturally.
- iv) What are your responsibilities as an informed individual? How do you intend to contribute professionally to the changing time?
- v) What is thermal comfort? Define heat loss, heat gain, and heat equilibrium with respect to the building.

